



Bouverie Road
Hardingstone,

oriordanbond
SALES & LETTINGS



Bouverie Road

Hardingstone

NN4 6EG

OFFERS OVER £325,000

GROUND FLOOR
984 sq.ft. (91.4 sq.m.) approx.

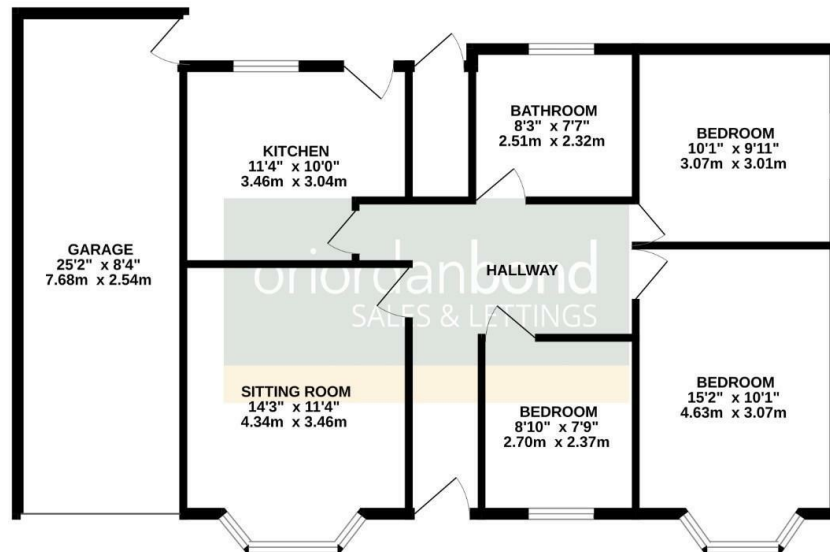

TOTAL FLOOR AREA: 984 sq.ft. (91.4 sq.m.) approx.
Whilst every attempt has been made to ensure the accuracy of the foregoing contained herein, measurements of doors, windows, rooms and any other items are approximate and no responsibility is taken for any error, omission or misstatement. This plan is for illustrative purposes only and should be used as such by any prospective purchaser. The services, systems and appliances shown have not been tested and no guarantee as to their operability or efficiency can be given.
Made with Metropix C2025

This detached bungalow in the popular location of Hardingstone sits proudly on a larger than average plot giving the property scope for further development.

With no onward chain the accommodation comprises entrance hall, sitting room, kitchen, three bedrooms and a bathroom. Externally the property has front and rear gardens with the a tandem length garage and off road parking. The property also benefits from gas central heating and uPVC double glazing. (C/984/M)

Additional information

- Council Tax Band:
- Energy Efficiency Rating: E

Viewing

Viewing strictly by appointment – details below

Disclaimer

O'Riordan Bond Estate Agents Limited has not tested apparatus, equipment, fittings or services and so cannot verify they are in working order. The buyer is advised to obtain verification from their solicitor or surveyor.

O'Riordan Bond Grange Park Sales
01604 432007

grangepark@oriordanbond.co.uk

